

CERTIFICATE OF LOCATION OF GOVERNMENT CORNER

NORTHEAST Corner of Section 20, Township 107N, Range 39W

5th Principal Meridian, State of Minnesota, County of MURRAY

At the corner location shown on the sketch:

On 8/27/2020 found a NO. 4 REBAR WITHOUT CAP FLUSH WITH ASPHALT
DATE

left monument as found lowered monument removed monument (explain)

On _____ placed a _____
DATE

SKETCH OF REFERENCE TIES

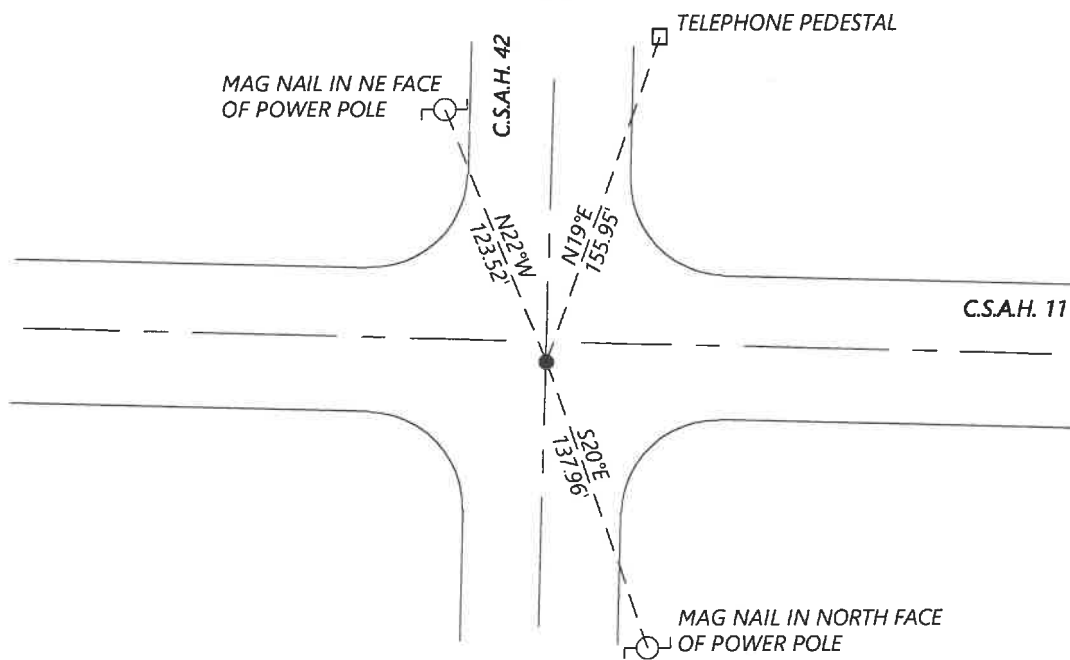

Statement of evidence for this corner location is on back of this page.

I hereby certify that this document was researched and prepared by me or under my direct supervision and that I am a licensed Land Surveyor under the laws of the State of Minnesota.

Signature [Handwritten Signature]

Date 6/16/2021 License No. 45874

Title:

- Land Surveyor Professional Engineer
- County Surveyor County Engineer

OFFICE OF THE COUNTY RECORDER

County of Murray

I hereby certify that this document was filed in the Co.

Recorder's office at _____ M. on the _____ day of _____ A.D. 20

County Recorder Karen Brown

by JUN 22 2021, Deputy

DOCUMENT NO. _____

Statement of Evidence:

Northeast Corner of Section 20, Township 107 North, Range 39 West, 5th Principal Meridian, Murray County, Minnesota.

No GLO Notes found.

- May 1901 Survey record for Section 17 show a stone in grade.*
- April 1978 Survey record for Section 20 shows that the corner was dug with a backhoe and nothing found.*
- Nov. 1987 Highway Department records show that a $\frac{3}{4}$ " iron pipe was placed at the corner.*
- May 1999 C.S.A.H. 42 plans show the corner at PI station 1+610.639*
- March 2000 Highway Department records show a $\frac{3}{4}$ " rebar was placed prior to the bituminous being laid.*
- Aug. 2006 A survey in Section 21 by Perry Zieske shows an iron monument at the corner. He lists the Murray County coordinates for the corner: N: 179318.54 E: 558853.26*
- Oct. 2015 A survey in Section 17 by Dennis Esplan shows a found iron monument at the corner.*
- Sept. 2020 Westwood Professional Services searched and found a No. 4 rebar, coordinates fit well to the 2006 Zieske survey.*

Analysis of the recovered data, field evidence and survey measurements, indicates that the monument found is the correct perpetuation of this corner. For additional information concerning this corner please contact Westwood Professional Services.